

The logo is centered on a dark navy blue background. It features four large, overlapping geometric shapes: a teal rectangle in the top-left, a yellow rectangle in the top-right, a white triangle at the top center, and a blue rectangle in the bottom-left. The text 'Kudos' is in a large, white, bold sans-serif font. Below it, 'BUILDING INNOVATION' is in a smaller, teal, all-caps sans-serif font.

Kudos

BUILDING INNOVATION

Welcome to Kudos

A unique atmosphere with workspaces featuring the best services and latest technologies to foster wellbeing and collaboration.



How did it come about?

Kudos was devised based on the conviction that everyone who co-exists in its workspaces have experiences that reflect its values, leave their mark and make them feel a part of this great community.



About Kudos









Kudos

INNOVATION CAMPUS

OMEGA

Avenida de la Transición Española, exit 17 from the A-1
28108 Alcobendas, Madrid

Location

Airport	 7 min
Chamartin train station	 10 min
A-1 motorway	 2 min
M-40 orbital motorway	 5 min
Alcobendas suburban commuter train station	 4 min
EMT municipal bus (lines 827,828)	 2 min

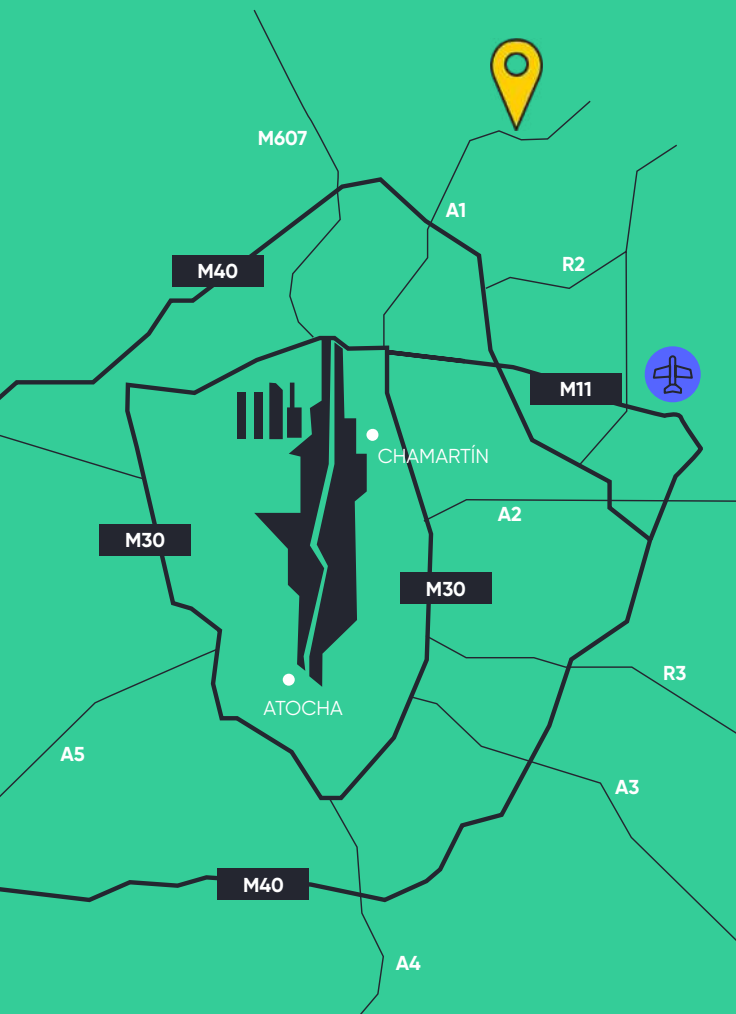

Omega

An office complex situated in Alcobendas with great visibility from Madrid's A-1 motorway. Its modern and innovative design, spacious floors, high-quality finishes and green areas have made it a reference in the office space market.



NEAR THE
A-1



42,400 m²



4 BUILDINGS



929 PARKING
SPOTS



OUTDOOR
COURTYARD



SHUTTLE BUS



FOOD SERVICE
AREA



GYM



The campus



CLEANING
SERVICES



SECURITY



EVENTS



HOTEL

It offers more than 42,400 m², divided among 5 buildings with 5 floors each, which makes it one of the most emblematic office complexes in the area.

A benchmark in the latest technology in the areas of energy, sustainability and tenant wellbeing, it features a modern and innovative design, spacious floors, high-quality finishes and energy savings measures. These values make it worthy of **"Very Good" BREEAM certification.**

In order to enhance the user experience and adapt to the needs of today's companies, innovative initiatives are currently being developed to improve mobility and the common areas.



Distribution

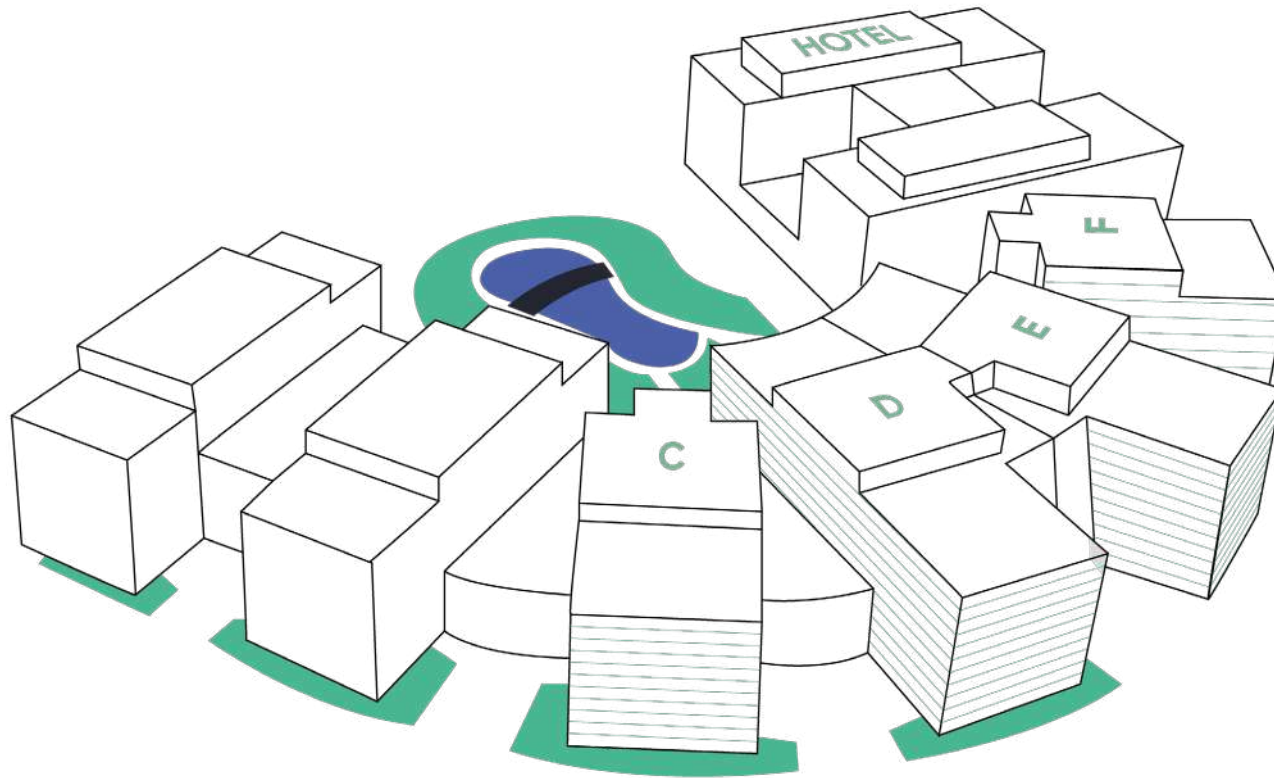

A	FLOORS	5
	SURFACE AREA	8,947 m ²
	PARKING SPOTS	158
C	FLOORS	5
	SURFACE AREA	7,567 m ²
	PARKING SPOTS	212
D	FLOORS	5
	SURFACE AREA	9,161 m ²
	PARKING SPOTS	160

E	FLOORS	5
	SURFACE AREA	9,161 m ²
	PARKING SPOTS	160
F	FLOORS	5
	SURFACE AREA	7,567 m ²
	PARKING SPOTS	216

THE FLOOR PLAN

A versatile and modular professional space that offers large surface areas with natural light and high ceilings.

- IMMENSE BRIGHTNESS
- EXTENSIVE FLOOR SURFACE AREA OF UP TO 1,733 m²
- CEILING CLEARANCE: 2.70 m



TECHNICAL CHARACTERISTICS

- ACCESS AND INTRUSION CONTROL
- FIRE PROTECTION SYSTEM
- 3 LIFTS
- CLIMATE CONTROL SYSTEM
- ELECTRICAL SYSTEMS
- AUTOMATION
- BMS

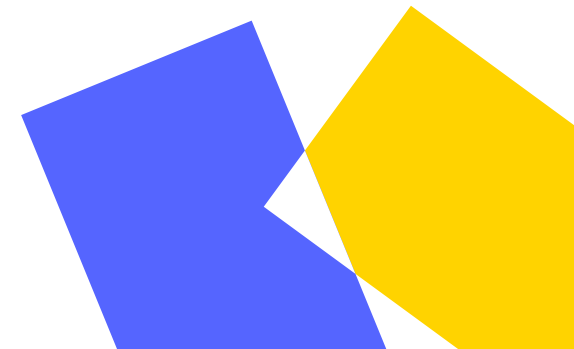

The Kudos Experience

Kudos makes people fall in love with the idea of going to work.

An open, flexible and interconnected community where people, technology, knowledge and activities foster professional relationships by combining interests, talent and personality.

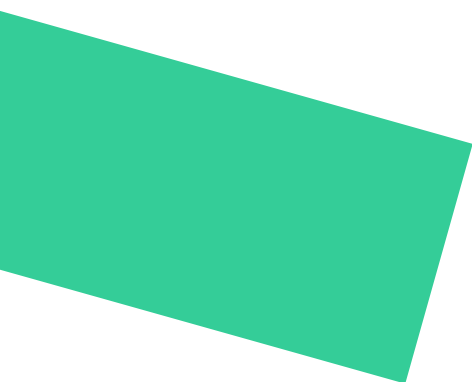



The objective is to attract and retain talent through excellence, fostering inclusion within the community, increasing awareness for environmental and sustainability issues, guaranteeing people's wellbeing and encouraging people to look after their minds and bodies besides making it easy to achieve a balance in people's work/personal life and boosting the use of technology to keep the community connected.

To this end, Kudos offers a **Community** at all of our workspaces as a unique and differentiating value proposal, the aim of which is to create experiences in exclusive, fun and welcoming atmospheres where people connect to each other and, thus, create synergies.

Living, feeling, sharing, connecting, laughing, creating. That's what unites us and ties us to places and people.



